

Imagine the possibilities...





Nema Associates Inc.
408 E. Elizabeth Ave. Linden, NJ 07036
(908) 275-3840

DISPLAY FOLIO[®]

Exhibit & Display Catalog

In the demanding environments where display products are relied on day after day, customers increasingly recognize the importance of quality and of having a partner who can support their evolving needs.

Whether you need one stock item or five thousand custom frames, we are committed to being your source for quality and value in visual merchandising.

We continue to invest to improve the quality of the products and services we deliver to you, our customers. It takes a team effort from our employees, whose priority is ensuring that your projects are successful. Our approach has always been to listen carefully to our customers, and to deliver products that meet your evolving display needs. We service a wide range of industries.

We are proud of our extraordinary reputation for quality, value and reliability. We source the finest quality components, and because we manufacture in the U.S., our supply chain is shorter, "greener", and we can offer customizable solutions tailored to your needs. We are excited about our future and look forward to continuing our pursuit of opportunities together!

Mercury Retractable Banner Stands™



RY1-S with LEDBR1 light.

MOST RELIABLE, BEST VALUE RETRACTABLE ANYWHERE!

- Sleek new styling
- Telescopic Pole
- Lightweight, portable
- Assemble without tools
- Handsome finishes
- No loose parts to lose



Matte black



Top crossbar with knob



RY1-S-HC hardcase kit

Model	Description	Width	Weight (lbs.)
RY1	1-sided	36"	12
RY2	2-sided	36"	18
RY3	1-sided	24"	11
RY4	2-sided	24"	14
RY5	1-sided	48"	14
RY6	2-sided	48"	23
RY7	1-sided	60"	18
RY8	2-sided	60"	29

Free Soft Travel Bag with every unit!

Model	Banner Stands with Hard Shipping Case	Weight (lbs.)
RY1-B-HC	RY1 36" single sided, black with hard case	25
RY1-S-HC	RY1 36" single sided, silver with hard case	25
RY2-B-HC	RY2 36" double sided, black with hard case	31
RY2-S-HC	RY2 36" double sided, silver with hard case	31
RY3-B-HC	RY3 24" single sided, black with hard case	24
RY3-S-HC	RY3 24" single sided, silver with hard case	24
RY4-B-HC	RY4 24" double sided, black with hard case	27
RY4-S-HC	RY4 24" double sided, silver with hard case	27

Case Dimensions 43" w x 14.5" d x 5" h

Specify: **-S** Satin Silver **-B** Matte Black



Good for many types of media substrates- vinyl, fabric, laminated film and more.*

*15 mil max. Laminate one side only. Must be pliable to roll up tightly.

MODELS UP TO 60" WIDE

- Infinite height adjustments 36" to 96"
- Very lightweight & portable
- Available single and double sided
- Instant set-up and take-down
- Telescopic pole system
- Aluminum construction
- Satin finishes

VELCRO® BRAND HOOK/LOOP MOUNT TOP & BOTTOM

Tremendous value & still made in the USA!

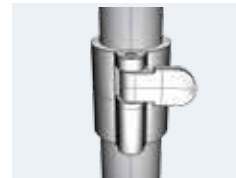

"G" Lock allows quick height adjustments.



2-sided case

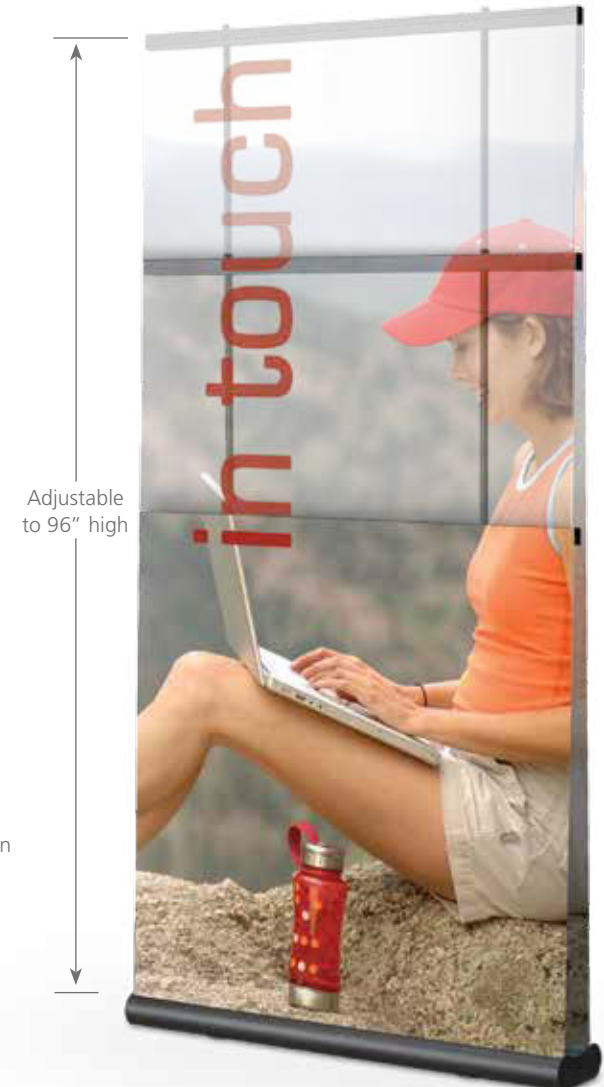

Compare ours versus the competition

- Tool-free assembly
- Infinitely adjustable up to 8 feet high
- Easy to use Velcro® brand hook & loop
- Free soft travel bag with every unit
- Built to last
- An incredible quality & value proposition
- Still made in the USA with pride!

Note: we use only Velcro® brand hook & loop with a pressure sensitive adhesive specially formulated not to damage graphics.

Hook comes attached to bar & leader. The loop attaches to the graphic top & bottom.

Classic Banner Stands™



POLE POCKET MOUNTING

Featuring:

- Adjustable height center poles and lightweight metal construction
- Top dowel holder attaches to pole top, bottom dowel holder can travel up & down
- User friendly and built to last!

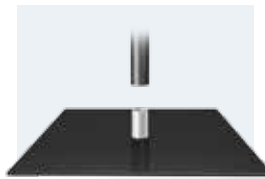

Square and round bases feature solid support bushing.



Solid aluminum adjustable clutch lock.



BN2SQ-B with **LEDBR2** light, and **PB1C** Brochure Holder.

QUALITY & VALUE

Model	Banners	Width	Sq. Base	Telescopic Height
BN1	1 or 2	12"	8"	24 - 42"
BN2	1 or 2	24"	12"	36 - 96"
BN3	1 or 2	36"	16"	42 - 118"

Colors:

-S	Satin Silver
-B	Matte Black

STANDARD BASES



12" Square. Heavy duty steel with inner support bushing & baked on powder coated finish.



TB Travel Base: Steel, modern design. Fits travel bag. Textured powder coated finish. No extra cost.

HEM GRAPHICS TOP & BOTTOM, DOWELS PROVIDED



Telescopic

Bottom holder adjustable

Simply hem banners top & bottom, put dowels in and slide into holders.

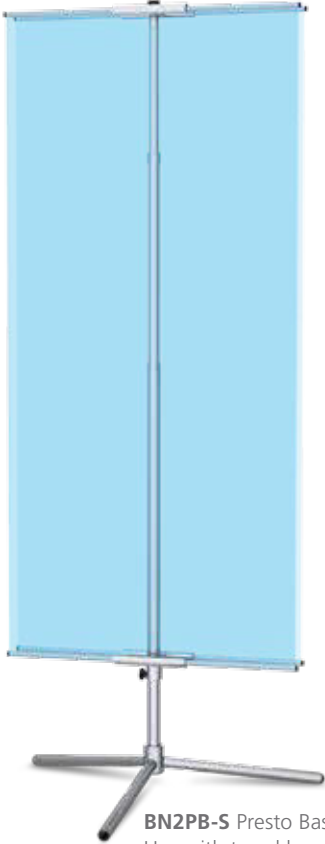

BN2PB-S Presto Base. Use with travel bags.



BN2TB-B Travel Base. Use with travel bags.



BN2RD-S Round Base. The most elegant style.

EXTRA COST BASES



RD Round Base: Heavy duty steel bases, beautiful baked on powder coated finish.
BN1: 1/8" x 6-3/4" (1-1/2 lbs.)
BN2: 3/16" x 11" (5 lbs.)
BN3: 3/16" x 15" (9 lbs.)



PB Presto Bases with internal shock cord mechanism, assembles like Presto! Use with travel bags.

Classic Banner Stands™



PB presto base.



TB travel base.

VELCRO® BRAND HOOK/LOOP MOUNT

- Trouble free clutch for secure locking
- Adjustable height 36"-96" center poles
- Bottom crossbar can travel up & down
- User friendly and built to last!
- Hook/Loop Mount top crossbar attaches to pole top

Available Colors:

-S	Satin Silver
-B	Matte Black



Oval crossbars with Velcro® brand Hook/Loop included.



Bottom crossbars can be raised and lowered.

Square Base	Travel Base	Presto Base	Round Base	Graphic Width
BV2SQ	BV2TB	BV2PB	BV2RD	24" Single
BV2DSQ	BV2DTB	BV2DPB	BV2DRD	24" Double
BV3SQ	BV3TB	BV3PB	BV3RD	36" Single
BV3DSQ	BV3DTB	BV3DPB	BV3DRD	36" Double

Custom variations available!

STANDARD BASES



Standard bases are square with inner support bushing, in a handsome satin silver or matte black finish.



TB Travel Base: Modern design. Fits travel bag. Textured powder coated finish. Same cost as square base specify **TB**.

VELCRO® BRAND HOOK/LOOP MOUNT



BV2SQ-B with **LEDBR1** light and **PB1C** Brochure Holder.



Crossbars feature aluminum brackets and Velcro® Brand Hook/Loop.



Centerpoles accept graphics 36" to 96" tall.



Solid aluminum adjustable clutch lock.

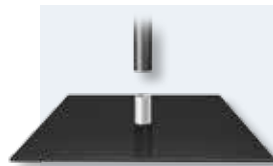

Solid inner bushing ensures stability.



Accessories
Lights, Bags &
Literature Baskets available.

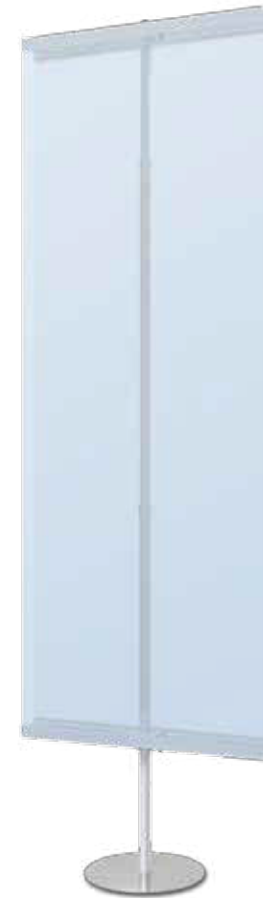

RD round base.



TB travel base.

EXTRA COST BASES



RD 11" Round 5 lb. base: Heavy duty steel bases, with inner support bushing, satin powder coated finish.



PB Presto Bases: Internal shock cord mechanism, assembles like Presto! Specify **PB**. Use with travel bags.

Nexus SnapBar Banner Stands™

NO GRAPHIC END FINISHING REQUIRED!



NX22-S

Aluminum satin anodized extrusions are strong and lightweight.

Metal springs provide great gripping power.

Easy Open SnapBars hold graphics firmly in place top & bottom

Tacky foam compresses ensuring a strong grip. Holds graphics to 1/16" thick.

Graphic end finishing not required.



Single Sided

OR



Double Sided

>



Fully Adjustable

SNAPBAR GRAPHIC MOUNTING

- Trouble free clutch for secure locking
- Adjustable height 36"-96" center poles
- Bottom crossbar can travel up & down
- User friendly and built to last!
- No graphic end finishing required



Centerpoles accept graphics 36" to 96" tall.



Solid aluminum adjustable clutch lock.

Choices:

1 sided or 2 sided
24", 30" or 36" width

- S Satin Silver
- B Matte Black

Model	Description	Width
NX21	1-sided	24"
NX22	2-sided	24"
NX251	1-sided	30"
NX252	2-sided	30"
NX31	1-sided	36"
NX32	2-sided	36"



Solid inner bushing ensures stability.
12" square steel base standard.



Optional Travel Base:
Folds up. Same cost - specify -TB.



Accessories: Lights, Bags
& Literature Baskets available.

INSTANT IMPACT



NX31TB-B



NX22-B

Harmony Banner Stands™

Is this the world's easiest to assemble, easiest graphic change banner stand system ever?



HMN4

Harmony Banner Stands

- 1" constant diameter clear anodized uprights. Sleek design.
- Swaged, spring button, and shock chord construction.
- Curved tops adds extra focus.
- Full width steel bases 12" deep offer substantial support.
- Tubing is clear anodized, Base color: Satin silver or matte black.
- Lightweight and portable.

Standard Models

Model	Base Width	Graphic Width	Height	Accessory Bag
HMN1	24"	23-1/2"	72"	EBP-2
HMN2	30"	29-1/2"	72"	EBP-3
HMN3	36"	35-1/2"	72"	EBP-3
HMN4	24"	23-1/2"	84"	EBP-2
HMN5	30"	29-1/2"	84"	EBP-3
HMN6	36"	35-1/2"	84"	EBP-3

Base Color: -S Satin Silver -B Matte Black



HMN4



HMN5



HMN6

Pillowcase Mounting

Very Fast Assembly

All Metal Construction

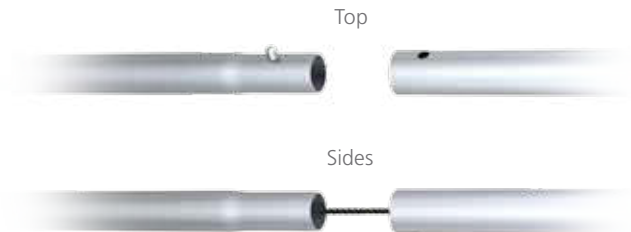

Swage, spring button, and shock-chord construction. Tool-free Assembly.

Packaging is very efficient & thus shipping is correspondingly inexpensive.



Accessory Bag EBP-2 inside dimensions 3" x 12" x 24"

Accessory Bars are available that accept standard slatwall shelves & accessories.

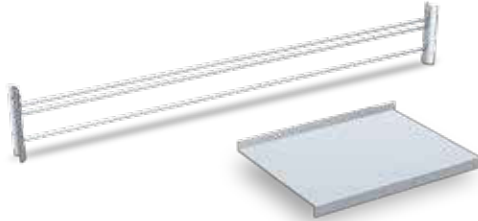

HMNB1	24" Accessory Bar
HMNB2	30" Accessory Bar
HMNB3	36" Accessory Bar
HMNS1	9-1/2" x 7" Accessory Shelf

These bars will NOT fit standard models.

The stands need to be prepared with mounting holes.

Specify how many accessory bars you would like per stand & our friendly sales staff can offer pricing on a project basis.



Graphic changes in less than 1 minute!

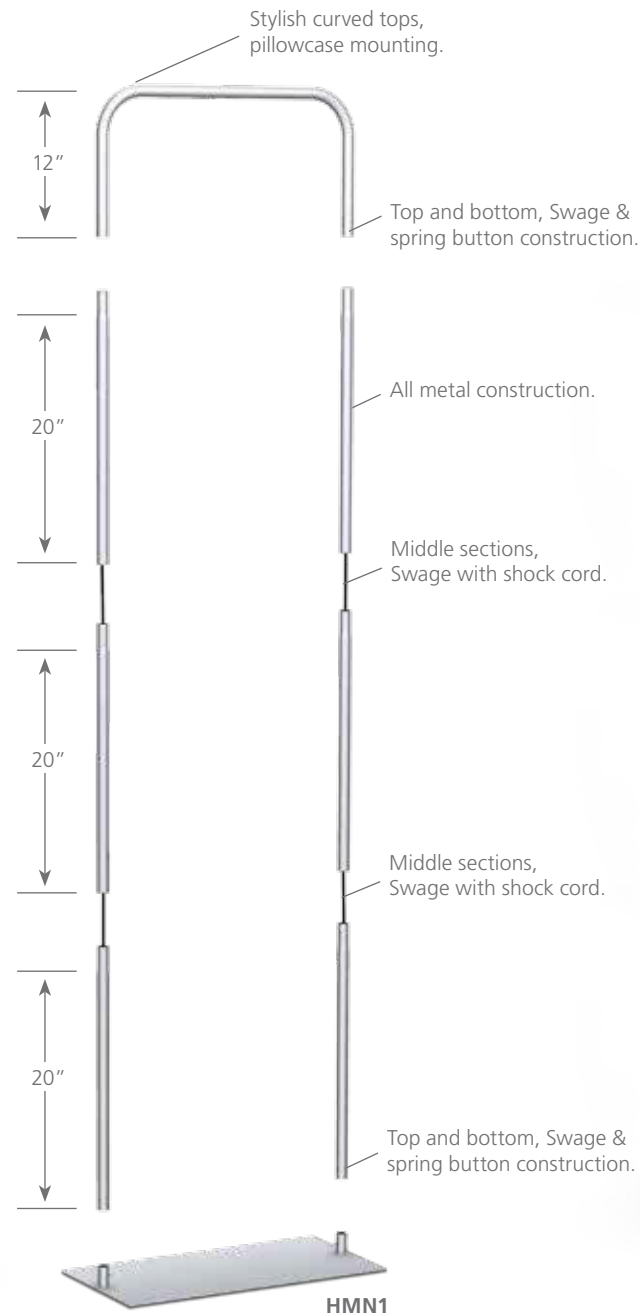

HMNS5 shown with three shelves and accessory bar assemblies.

Quest Banner/Sign Stands™

ALL METAL
QUALITY & VALUE

- Telescopic aluminum tube, opens to 7'
- Quick easy 2 minute assembly
- All metal unit-welded top, built to last
- Handsome matte finishes

FOR GRAPHICS WITH HOLES OR GROMMETS



QBS2H-B



QBS2H-B



Solid aluminum adjustable clutch lock.



Curved 25" long top steel rod.
2 welded metal J hooks
set on 18" centers.

SHOVEL BASE CAN FIT
UNDER SKIDS OR PRODUCT.

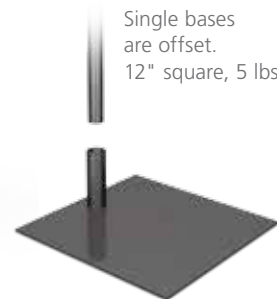

Single bases
are offset.
12" square, 5 lbs.

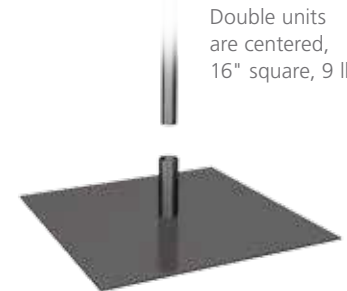

Double units
are centered,
16" square, 9 lbs.

Featuring 6" long support sleeves.

Single Wing Quest

QBS2H 25" curved rod with 18" centered J hooks

Double Wing Quest

QBS3H (2) 25" curved rods with 18" centered J hooks

Specify Colors:

-S Satin Silver **-B** Matte Black

Accessories

SnapGraphic Gripper Bars



Includes top & bottom grippers plus 2 universal mounting clips.

- No pockets or graphic end treatment required
- Grip graphics to .70 mil (.070") thick

GC22-C 22" **GC24-C** 24"

Dowel Kit with Eyebolts

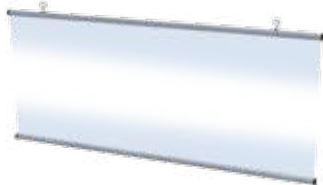

- 5/8" diameter - removable eyebolts on 18" center to center.

QBDK2 24" long dowel kit (set of 2)

Choose: **-S** Satin Silver **-B** Matte Black



- Perfect for many retail applications.
- Custom versions available in quantity.

CUSTOM MADE
MODELS AVAILABLE

Ultra UB Banner Stands™



Floor-to-Top Graphics
(No Visible Feet)

VELCRO® BRAND HOOK/LOOP MOUNT



Weighted bottom bar
includes hook & loop.



Alloy top bar also
includes hook & loop.



Spring loaded design
creates graphic tension.

Featuring:

Floor-to-top graphics, no visible feet, an incredibly clean look

Beautiful Black Matte Finish

- Suitable for any substrate
- "Footless" Design, floor-to-top graphics
- Clean edge to edge display
- Spring-loaded graphic tension
- Two minute assembly and take down
- Easy to assemble, pressure sensitive adhesive
- Hook & loop included for the top & bottom
- Telescopic aluminum alloy assemblies
- Modern curvilinear design & matte black finish
- Ideal for most inkjet media

Model	Height	Banners	Width	Wt. (lbs.)
UB324	42-72"	Single	24"	5
UB336	42-72"	Single	36"	7
UB424	42-72"	Double	24"	7
UB436	42-72"	Double	36"	9



EBGX

Travel Bags (imported):

EBGX For 36" & smaller models.

EBG8 For 48" models.

LARGE FORMAT SIZES

Model	Height	Banners	Width	Wt.
UB524	42-96"	Single	24"	6 lbs.
UB536	42-96"	Single	36"	8 lbs.
UB548	42-96"	Single	48"	9 lbs.
UB624	42-96"	Double	24"	7.5 lbs.
UB636	42-96"	Double	36"	9 lbs.
UB648	42-96"	Double	48"	11 lbs.

... Spring loaded design creates graphic tension

Handsome Matte Black Finish

3 Presentation Angle Positions

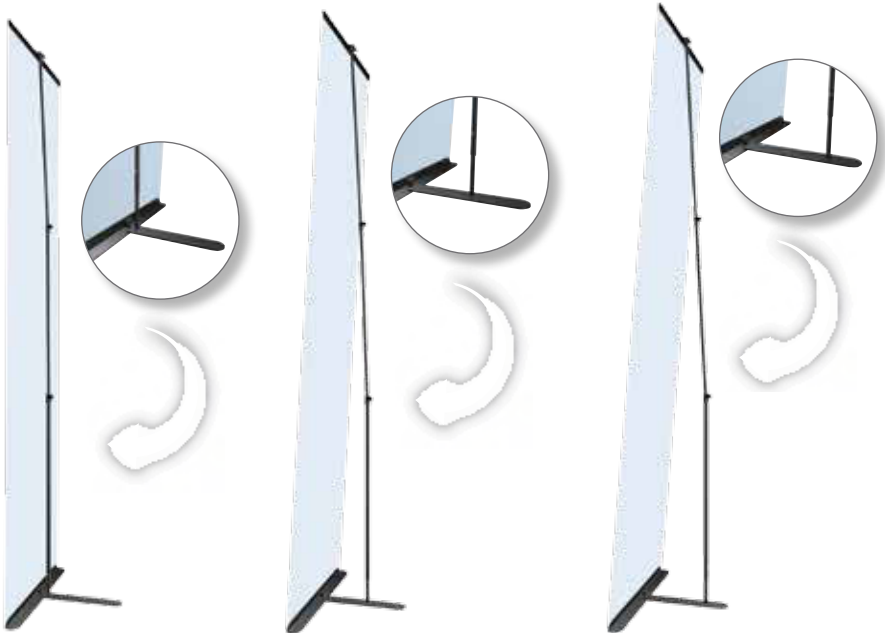

UB548 48" single sided



Double units have radiused bottom legs. Center support is held with knobs.

GripGraphic Banner Stands™



GS2-S
with square base.

SNAPGRAPHICS GRIPPER BARS™

Ingenious bar snaps closed after graphic insertion with incredible strength, torque and care.

- 4 bars included with every stand
- Telescopic uprights with knurled locks
- Display 1 or 2 graphics, back to back



Model	Height	Width	Standard Base*	Presto Base PB **	Round Base RD **
GS2	36" - 96"	24"	12" square	Shock Chord	11"
GS3	42" - 118"	36"	16" square	NA	15"

-S Satin Silver or -B Matte Black *TB Travel Base same cost **Extra cost



GS2RD-B
with round base.

STANDARD BASES



Standard bases are square with inner support bushing, in a handsome matte silver or black powder coated finish.



TB Travel Base: Modern design, fits travel bag. Powder coated finish. Same cost as square base specify **TB**.



Diamond pattern knurled twist lock.



Inner bushing ensures stability of square & round bases.

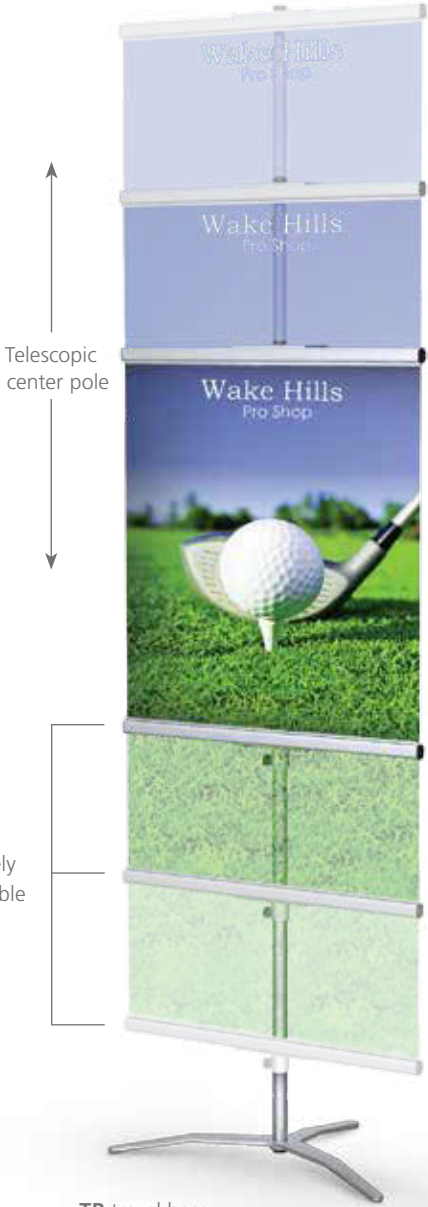

ACCESSORIES
Lights, bags, literature baskets available.



PB1C & PB2C for GS2.
PB3C & PB4C for GS3.

EXTRA COST BASES



RD Round Base: Heavy duty steel bases, with inner support bushing, satin powder coated finish. Perfect for retail environments.



PB Presto Bases: Internal shock cord mechanism, assembles like Presto! Specify **PB**. Use with travel bags.

GCO GripGraphic Banner Stands™



GRIPGRAPHIC BARS™

Oval co-extruded bars deliver exceptional gripping power at an economical price point.

- No pockets or graphic end treatment required
- Telescopic upright holds graphics up to 96" high
- Closes easily once graphic is inserted
- Bars hold 24" wide graphic media to 3/32" thick

No pockets or graphic end treatment required!

GCOBS1	Holds one 24" Banner
GCOBS2	Holds two 24" Banners

SATIN SILVER FINISH

ACCESSORIES



Literature baskets



PB2C



Bases feature an inner support bushing and a handsome matte satin silver finish.

Silver polymer cases simulate aluminum. (without the cost).

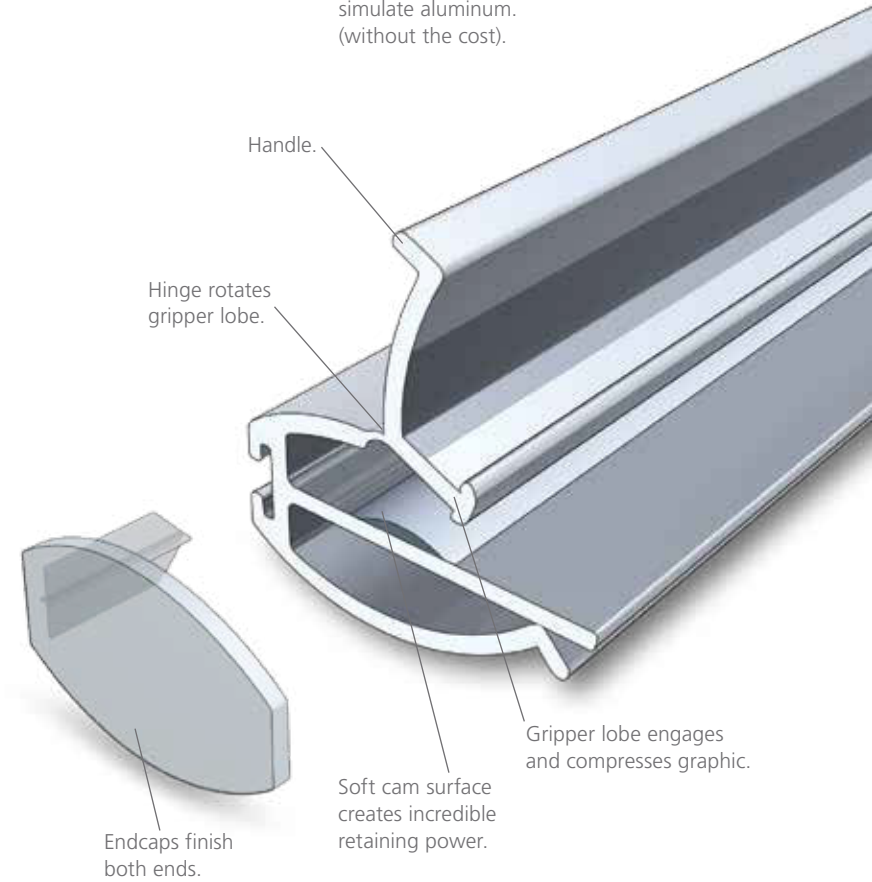

Patented Technology!

U.S. Utility Patent # 6,637,716
U.S. Design Patent # D-424,120

ECONOMICAL, PORTABLE!



BDG2-S

- 72" Height, single sided
- 12" square, 3-3/4 lb. base
- 1/2" Aluminum dowels
- Braided rope
- 2 section 1" tube assembly

Model	Width
BDG1	24"
BDG2	30"

-S	Satin Silver*
-B	Matte Black*

*Does not affect price



Diamond braided rope fits slot in dome shaped cap.

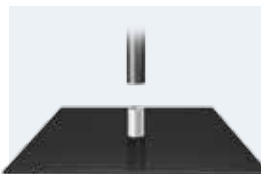

Inner bushing ensures stability of 12" square base.

Custom Models Available.

STURDY STEEL SHOWROOM STAND

- Holds one 28" wide hemmed banner
- 6' high, 1" diameter steel construction
- Bottom dowel supplied
- Handsome curvilinear design
- Two minute assembly



Perfect for automotive showrooms!



Use **HEMMED GRAPHICS**

Model	Color
LBS-B	Black



Promo Banner Stands™



MB2-B

Telescopic center pole

Infinitely Adjustable

PROMO BANNER STANDS

- Adjustable height, all stands accept graphics up to 72" high
- 3 Mounting Choices: Pole Pocket, SnapGraphic™, Hook/Loop
 - Great price points!

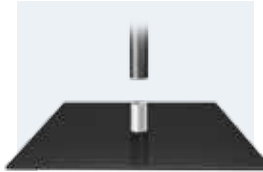

Solid inner bushing ensures stability.

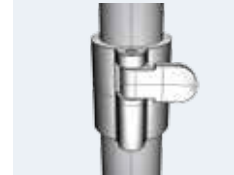

"G" Lock allows quick height adjustments to 72".
5/8" & 3/4" aluminum tube diameters.

Model	Mounting	Width
MB1	Pole Pocket	Single 24"
MB2	Pole Pocket	Double 24"
MB3	Hook/Loop	Single 24"
MB4	Hook/Loop	Double 24"
MB5	SnapGraphic™	Single 24"
MB6	SnapGraphic™	Double 24"

Other widths available special order.
Stands close to 38-3/8".

Specify Color:

-S Silver -B Black
same cost

STANDARD BASES



SQ Standard Square Base:
12" steel base, 3-3/4 lbs.
Powder coated finishes.



TB Travel Base:
No extra cost. Simply specify **TB**,
use with **EBGX** travel bag.



MB3SQ-B, shown with bottom holder 30" off floor, **LEDBR1** Light, and **PB5C** Brochure Holder.

POLE POCKET MOUNT

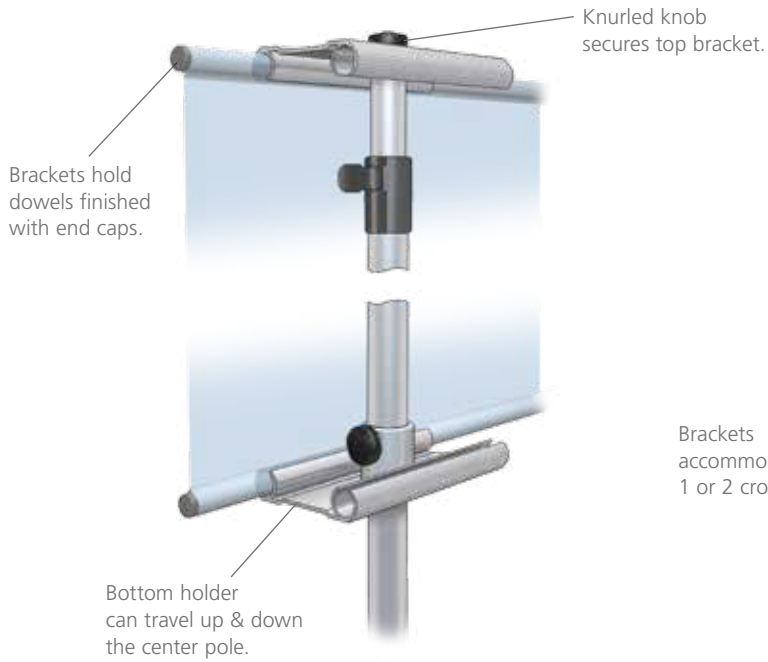

SNAPGRAPHIC™ MOUNT

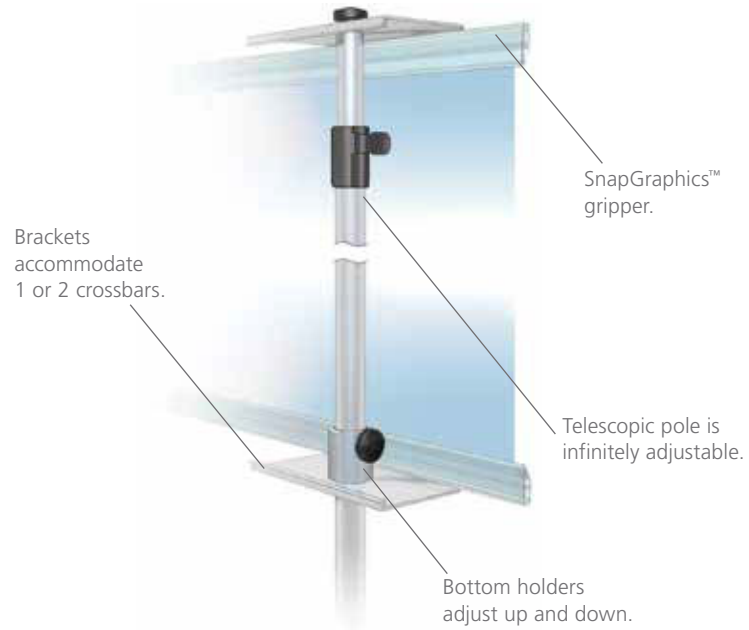

HOOK/LOOP MOUNT

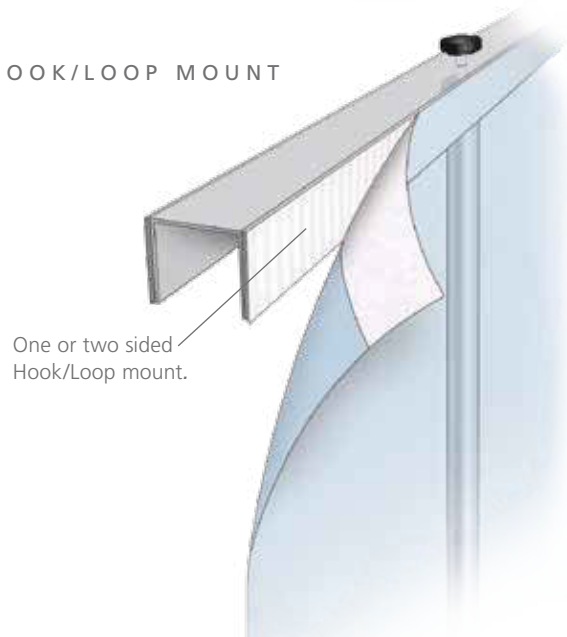

ACCESSORIES:
Lights, bags, literature baskets available.



Adjustable Large/Grand Format Banner Stands™

SUPER STURDY CONSTRUCTION — FEEL THE QUALITY DIFFERENCE



Adjustable width

Features:

- Telescopic height 36"-96"
- Pole pocket mounting
- Two 3" x 17" formed steel bases
- Great portability. 5 minute assembly

Standard Tubing

Model	Width	Upright Diameters	Crossbar	Hem
BN4	30"-48"	3/4"-7/8"-1"	1-1/8" Diameter	2"
BN5	52"-96"	3/4"-7/8"-1"	1-1/8" Diameter	2"
BN6	24"-42"	3/4"-7/8"-1"	1-1/8" Diameter	2"
EBG6	Travel bag suitable for above stands			

Specify Colors:

-S Satin Silver -B Matte Black

Jumbo Diameter Tubing

Model	Width	Upright Diameters	Crossbar	Hem
JN4	30"-48"	1-1/4"-1-3/8"-1-1/2"	1-5/8" Diameter	3"
JN5	52"-96"	1-1/4"-1-3/8"-1-1/2"	1-5/8" Diameter	3"
JN6	24"-42"	1-1/4"-1-3/8"-1-1/2"	1-5/8" Diameter	3"
EBG6	Travel bag suitable for above stands			

Note: For heavy weight vinyls & graphics, special order uprights with **B** locks. Extra cost applies.

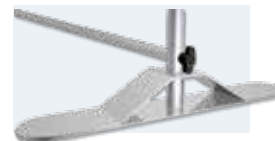

Sturdy Steel
"Bridge" Support Base.



Twist lock offers infinite
horizontal and vertical adjustments.

Adjustable Large/Grand Format Banner Stands™

ACCESSORIES:

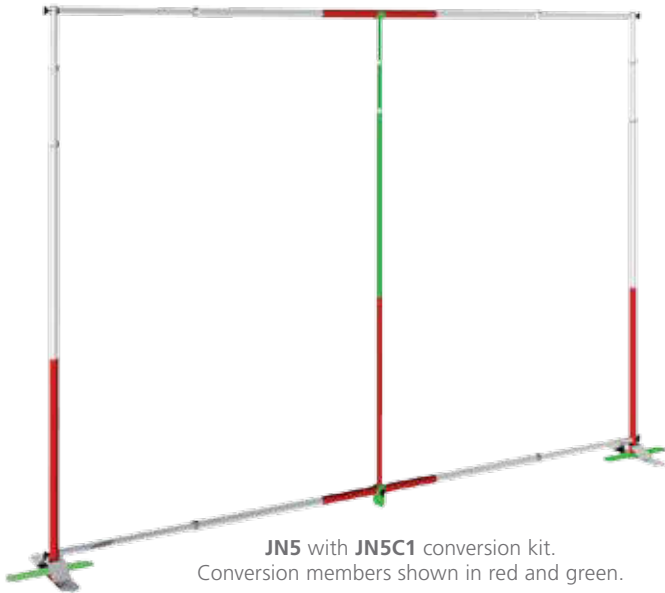

Conversion Kits for Grand Format!

convert **BN5** & **JN5** up to 10' & 12' high & wide.

BN5C1	10' Kit for BN-5	5 inserts & 1 center support
BN5C2	12' Kit for BN-5	10 inserts & 1 center support
JN5C1	10' Kit for JN-5	5 inserts & 1 center support
JN5C2	12' Kit for JN-5	10 inserts & 1 center support
EBG6	Travel bag holds 1 conversion kit	
EBGH	Travel bag holds 1 conversion kit & 1 banner stand	

Note: Center support requires a notch in the banner back.

Specify Colors:

-S Satin Silver **-B** Matte Black



EBGH Travel Bag (imported): will hold a banner stand and a conversion kit.



EBG-6 Bag (imported): Designed for these stands, One bag is required for each banner stand or conversion kit.

Snap-on—Literature Holders

PB1C	4" w by 2" d	pamphlet	BN's
PB2C	9" w by 2" d	catalog	BN's
PB3C	4" w by 2" d	pamphlet	JN's
PB4C	9" w by 2" d	catalog	JN's



PB1C/PB3C



PB2C/PB4C

Extra Crossbar Kits

Accessory telescopic crossbar attaches anywhere along the uprights. Includes 2 snap-on glide sizes.

BN4SOC	for BN4
BN5SOC	for BN5
BN6SOC	for BN6
JN4SOC	for JN4
JN5SOC	for JN5
JN6SOC	for JN6

Rings

RG5 Set of 4 rings holds foam core or plastic graphics with grommets.



Classic Fixed Width Banner Stands™

LIGHTWEIGHT, STRONG - POLE POCKET MOUNTING

- Aluminum alloy
- Tube diameters 3/4"-7/8"-1"
- Telescopic height 36"-96"
- Hem for 3/4" diameter crossbars

Specify: Model—Base*—Color*

Model	Crossbar Width
B2X	24"
B25	30"
B3X	36"
B4X	48"

Base*	
BR	Bridge
RD	9" Round Base

Color*	
-S	Satin Silver
-B	Matte Black

*Does not affect price, but must use to order.

Step Crossbar Kits

Adapters and a bar for attaching banner anywhere on upright.

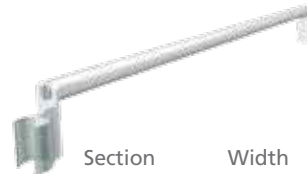

Section	Width
SCK1	24"
SCK2	30"
SCK3	36"
SCK4	48"



EBG6 (imported): Bag for bridge base models, 36" max.



Super strong construction.



PK aluminum pucks an extra cost option, offer a sleek clean look.



Bridge Base

Round Base



B4XRD with **PK** Pucks in lowered position

TOWERS & PARTITIONS - POLE POCKET MOUNTING

- Telescopic height 36"-96"
- Tube diameters 3/4"-7/8"-1"
- Attractive 9" round bases
- Hem for 7/8" diameter crossbars
- 5 minute set-up

Triangular Tower	Square Tower	4 Section Partition	Crossbar Width
TR1	SQ1	PT1	24"
TR2	SQ2	PT2	30"
TR3	SQ3	PT3	36"
TR4	SQ4	PT4	48"
TW24	24" Vertical Extensions (sold each)		

Colors: -S Satin Silver -B Matte Black



Easy assembly.

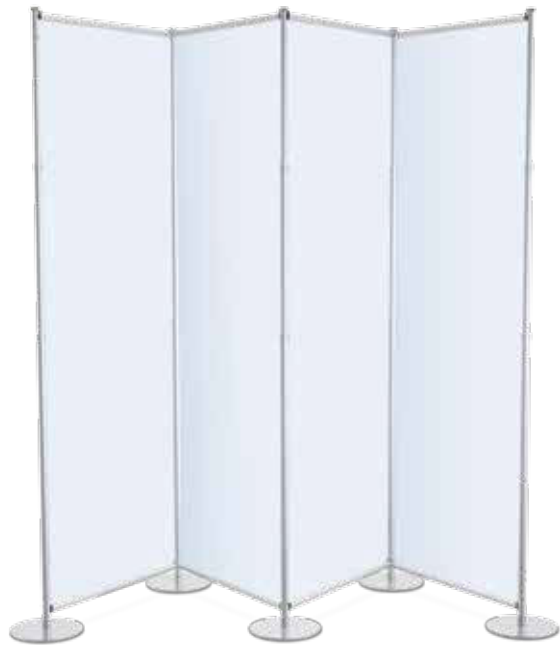

PT2



TR1 with PB1C pamphlet holders.



SQ2

Apollo SnapGraphics Stands™



SNAPGRAPHICS™ BAR

Holds any substrate up to 70 mil. thick.



Bottom crossbar can be set at
28" - 36" - 48" & 60" from top

No pockets or
graphic end treatments required!

Apollo™ Stands

- Aluminum alloy
- 70" tall uprights
- 9" round bases
- Patented Crossbars

Model	Wide
AS1	22"
AS2	24"
AS3	36"
AS4	48"
AS5	60"

Options:	
-S	Satin Silver
-B	Matte Black

PK Aluminum Pucks
rather than knobs



Round knobs
standard



PK aluminum pucks
an extra cost option



Roll-A-Round
base available



Telescopic Apollo™ Stands

- Same great features as Apollo™, but height is telescopic to 90"
- 11" round bases
- Knurled twist lock for secure height adjustments
- 4 Positions for bottom crossbar at 4" - 18" - 24" & 30" off floor

SNAPGRAPHICS™ BAR

Holds any substrate up to 70 mil. thick.



Solid aluminum clutch lock.

No pockets or graphic end treatments required!

telescopes to 90"



Model	Wide
AST1	22"
AST2	24"
AST3	36"
AST4	48"
AST5	60"

Options:

-S	Satin Silver
-B	Matte Black

PK Aluminum Pucks rather than knobs



Bottom crossbar can be set at 4" - 18" - 24" & 30" off floor, while top bar is telescopic.

Literature Baskets



PB1C



PB2C

PB1C and PB2C snap on uprights.

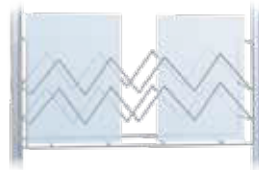

AS1PB (Limited Use)

AS1PB and AS2PB must be ordered with stands.

PB1C	4" w x 2" d
PB2C	9" w x 2" d
AS1PB	for AS1 only
AS2PB	for AS2 only

Brochure Holders & Exhibit Lighting

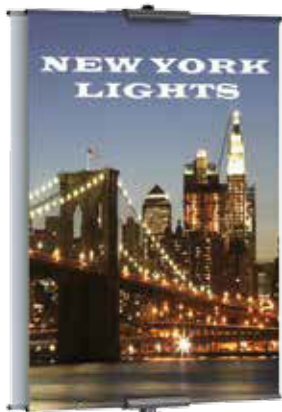

BN2-B
with **PB1C**

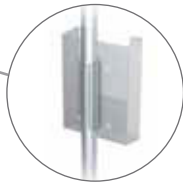

Simple Snap-on design.

Snap-on—Brochure Holders



Wire	Acrylic	Size	Grip Diameter
PB1	PB1C	Pamphlet	1" diameter
PB2	PB2C	Catalog	1" diameter
PB3	PB3C	Pamphlet	1-1/2" diameter
PB4	PB4C	Catalog	1-1/2" diameter
PB5	PB5C	Pamphlet	3/4" diameter
PB6	PB6C	Catalog	3/4" diameter

Pamphlet: 4" w x 2"D

Catalog: 9" w x 2" D

Light Outfit



Light Outfit

Clamp On Exhibit Lights (imported):



EX4



UELA
Universal Exhibit Light

EX4	Bright 18w LED light with C clamp base - opens 1-1/2"
UELA	3" clamp, 18" flexible arm, aluminum reflector, accepts 75w max.

- Outstanding light source includes 10" diameter reflector and a special 75 watt bulb that simulates natural daylight.
- Ideal for mixing colors.
- Light canvas or model
- 3-section stand extends to 7'.
- Also available without bulb (124/3A).
- Weight: 4 lbs.

124/3A	Packed each in 2 boxes, 6 per carton
124/3A1	Same as above but individually boxed
124/3NL	Includes 75 watt North Light bulb that simulates daylight
75WNL	Bulb only
100/3	Light Stand only

Use above for two sided support models: BN6, BN4, BN5, JN4, JN5, and fixed width stands.

Cascade LED Lights™

For
Portable Graphic Stands, Pop-Ups
and Banner Stands

Imported



LED Light Source

- Extremely bright 450 Lumens
- Cool white color temperature
- 6 watt, 12 volts, 10-1/2" wide
- 50,000 working hour lifetime
- Wide movable swivel head



Accessory Bag fits all Cascade Lights
EBGC 22" x 4" x 3"



LEDBR1

Cascade LED Light Source with bracket for one-sided banner.



LEDBR2

2 Cascade LED lights with bracket for two-sided use.



LEDLF

Cascade LED Light Source with clamp for banner stand attachment.



LEDPU

Cascade LED Light Source with bracket for for Pop-Ups.



LEDCC

Cascade LED Light Source with C Clamp for multipurpose use.



Use for Banner Stands:

BN2, BN3, BV2, BV3, RY1, RY3, RY5, RY7 (2), NX21, NX251, NX31, GCOBS1, UB3, UB5, GS2, GS3, MB1, MB3, MB5.



Use for Banner Stands:

BN2, BN3, BV2, BV3, RY2, RY4, RY6, RY8, NX22, NX52, NX32, GCOBS2, GS2, GS3, MB2, MB4, MB6.



BN4, BN5 (2), BN6, JN4, JN5 (2), JN6, B2X, B25, B3X, B4X, Apollo Stands, Straight Flat Walls (2), Visual Graphic Stands, Cobra, Crescent, Mega Wave Walls, Cool C Walls.



Use for:

Presto Pop-Ups, Collage Pop-Ups, & most other manufacturers pop-ups.



Great for:

Table tops, and flat divider walls. Clamps to horizontal and vertical surfaces. Grip range open to 2-1/2".

Travel Bags



EBGX Bag with **BN-25TB** inside

EBGX For Models BN, BV, MB, and GS stands that have TB Travel Bases or PB Presto Bases. Also good for UB stands (except 48" models). Bag is 44" long & has top zippered compartment.



EBGH

EBGH Padded carry case, 39" long, features 4" round protected graphic holder and a compartment to hold lights and extensions. Good for all Model BN2, BV2, & GS2 Banner Stands with TB Travel or PB Presto Bases; also good for UB, JN4, 5, & 6, BN4, 5, & 6 Banner Stands.



EBG8

EBG8 54" long single compartment bag.

EBG9 63" long single compartment bag, (not shown).



LNB1

LNB1 33" x 18" x 13" Duffle type carry bag.



EBGC

EBGC 22" x 4" x 3" bag for lights.



EBG6 Bag with **BN4S**

EBG6 For all two-sided support models BN4, BN5, BN6, JN4, JN5, JN6, B2x8, B258, B3x8. Multipocketed bag has full length center zipper. Length 40".



EBGM

EBGM Huge, monster sized soft nylon bag, for multipurpose use. 79" w x 22"h x 2" d

SNB1 33" x 12" x 13" Duffle type carry bag. (not shown).



EBGLR

EBGLR Well designed nylon carry bag for portable use. Features a special compartment with straps to hold 12" square base securely. 24" x 9-1/2" x 12".

All bags on this page
are imported.

A TERRIFIC NEW PADDED BAG SERIES
with lots of great features sized for excellent utility.

Inside are tube compartments
and room for graphics.

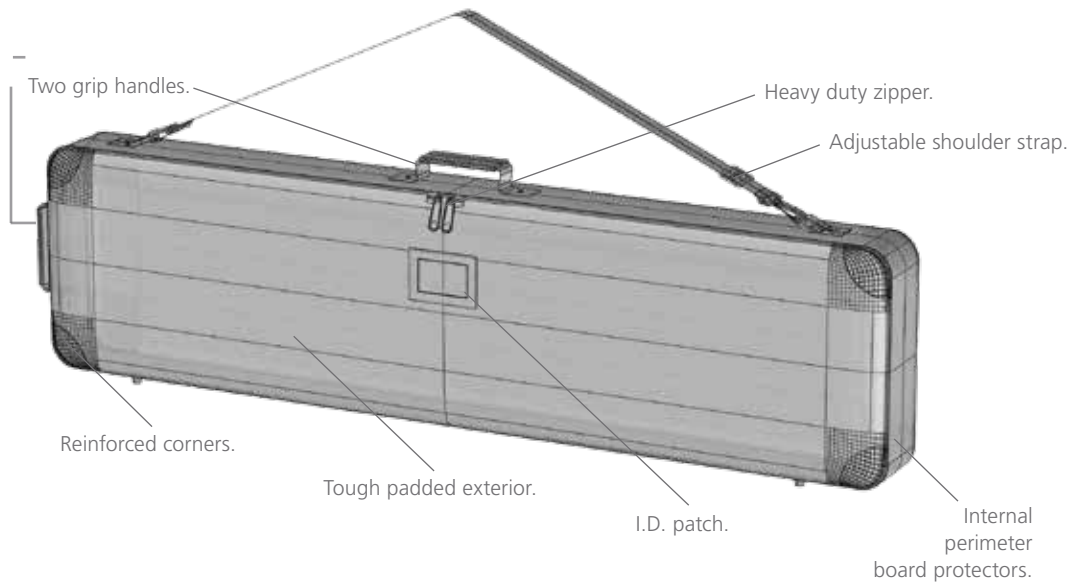

EBP2 Inside dimensions 3" x 12" x 24".



EBP3 Inside dimensions 3" x 12" x 36".

EBP2: HMN1, HMN4, VG62, PVT1, PVT2, SBR1TP, SBR2TP, SBR3TP, SBR7TP, SBR8TP, SBR9TP, 1PDTR, 1PPDTF, BN1

EBP3: HMN2, HMN3, HMN5, HMN6, RY1, RY2, RY3, RY4, BN2, BV2SQ, BV2DSQ, NX21, NX22, NX251, NX252, NX31, NX32, GS2, BN4, BN5, BN6, JN4, JN5, JN6, B2X, B25, B3X, TR1, TR2, TR3, VCST1, VCST2, FW088, VG63, VG64, VG82, VG83, VG84, C3, GCOB51, GCOB52, PVC3, PVC3C, PVC4, PVC4C, PVC5, PVC5C, PVC6, PVC6C, PVT3, PVT4

EBP4: RY5, RY6, CBR2, CBR3, CBR4, CENT2, CENT3, CENT4, UB324, UB336, UB424, UB436, UB524, UB536, UB548, UB624, UB636, UB648, MB1, MB2, MB3, MB4, MB5, MB6, B4X, SBR1, SBR2, SBR3, SBR7, SBR8, SBR9, C2, COH1, IPDSRD, IPDSSQ, IPHB2, IPHC1, IPHC2.



EBP4 Inside dimensions 3" x 12" x 48".

Hard Shipping Cases

Cases on this page are made in the U.S.A.

Made in the U.S.A.

Models: HC3919, HC4526, HC4840, HC5315, HC5325, HC6522:
Rugged thermoformed polyethylene construction

Models: HC4213, HC6317, HC6326: Fabricated board,
steel reinforced corners, riveted construction.

- Strong steel rubber grip handles
- Large 8" x 12" label area
- Steel rubber grip carrying handle
- Sturdy 1-1/2" straps with buckles
- Heavy duty built-in durable wheels



HC3919



HC4840



HC4526



HC5325



HC5315



HC4213



HC6326

HC3919	39" x 19" x 5-1/2"	20 lbs.	Thermoformed
HC4526	45" x 26" x 9-1/2"	28 lbs.	Thermoformed
HC4840	48" x 40" x 45"	27 lbs.	Thermoformed

HC5315	53" x 15" x 12"	25 lbs.	Thermoformed
HC5325	53" x 25" x 10"	34 lbs.	Thermoformed
HC6522	65" x 22" x 9"	33 lbs.	Thermoformed

HC4213	42" x 13" x 5"	11 lbs.	Fabricated Board
HC6317	63" x 17-3/8" x 12"	24 lbs.	Fabricated Board
HC6326	63" x 26" x 9-1/2"	30 lbs.	Fabricated Board

Note: Some of these cases ship dimensional weight, not actual weight via UPS or FedEx.

Podium & Exhibit Cases

Cases on this page are imported.

Podium Cases

Podium Cases are hard plastic designed for Pop-Ups. Doubles as a Podium, add a graphic wrap to deliver your message. OPC1: Wt. 40 lbs., OPC2: Wt. 26 lbs. OPC1 has a simulated wood top.



OPC1



OPC1 with GFW1



OPC2
(2 units shown)



Podium Travel/Storage Cases (imported):

OPC1	24" w x 15-1/2" d x 38" h (O.D.) Podium Case
GFW1	Laminated Graphic for OPC1. Size: 70-1/2" w (includes 2" overlap) x 31" h
OPC2	16-1/4" w x 14-1/2" d x 34-3/4" h (O.D.) Half Podium Case
GFW2	Laminated Graphic for OPC2. Size: 50-1/2" w (includes 2" overlap) x 27-1/2" h

Portable Exhibit Cases

Stylish design and versatile portability at a reasonable cost. Great for transporting Presto Pop-Ups™ and Collage Pop-Up™ units.

- Padded soft outer shell
- Rigid protective plastic liner
- Airline checkable
- Tough, yet lightweight



Wheels have protective outer enclosures.

EGC1	12" x 12" x 35"
EGC2	16" x 16" x 35"
EGC3	9-1/2" x 9-1/2" x 40"



Pull handle and side strap.



EGC2



EGC3

AIRLINE
CHECKABLE



EGC1

HAVE IT BOTH WAYS:
The light weight of a soft padded bag
WITH THE
Protection of a rigid liner



nema

MARKETING & DESIGN AGENCY

NEMA ASSOCIATES INC.

THE **DISPLAY FOLIO**
Exhibit & Display Catalog

(908) 275-3840

408 E ELIZABETH AVE. LINDEN, NJ 07036

Visit www.nemadesign.com to view or download a digital copy of this catalog.